

# Hybrid 2-Phase Stepper Servo Motor W/1000PPR Encoder

General Specifications		Electrical Specifications	
Step Angle	1.8	Rated Voltage (V)	3.2
Number of Phase	2	Rated Current (A)	1.2
Shaft Diameter (mm)	14	Resistance Per Phase (Ω)	0.44
Encoder Resolution (CPR)	1000	Inductance Per Phase (mH)	4.4
Insulation Class	Class B	Holding Torque (Kg.cm)	85
Length (mm)	118	Detent Torque (g.cm)	2500
Weight (Gms)	1000	Rotor Inertia (g.cm <sup>2</sup> )	2700

## Speed→Torque Graph

## Wiring Diagram

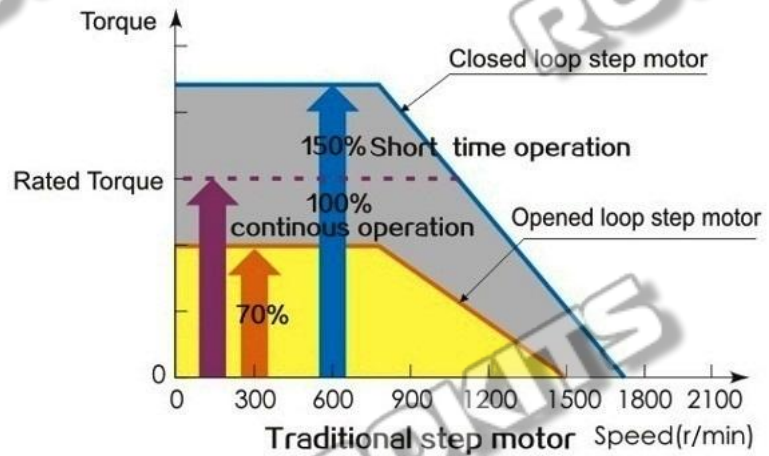
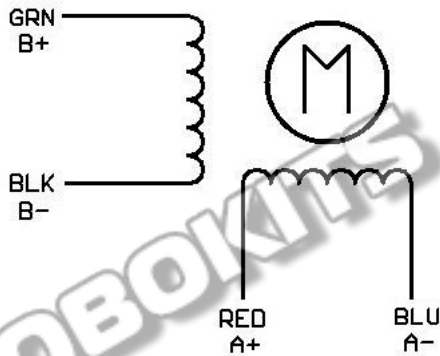

## Encoder Pin-Outs (DB9)

DB9 Pin No	Description	Wire Colour
1	0V	Black
2	+5V	Red
3	A-	Green
4	A+	Yellow
5	B-	White
6	B+	Blue

## Dimensions (Unit = mm)

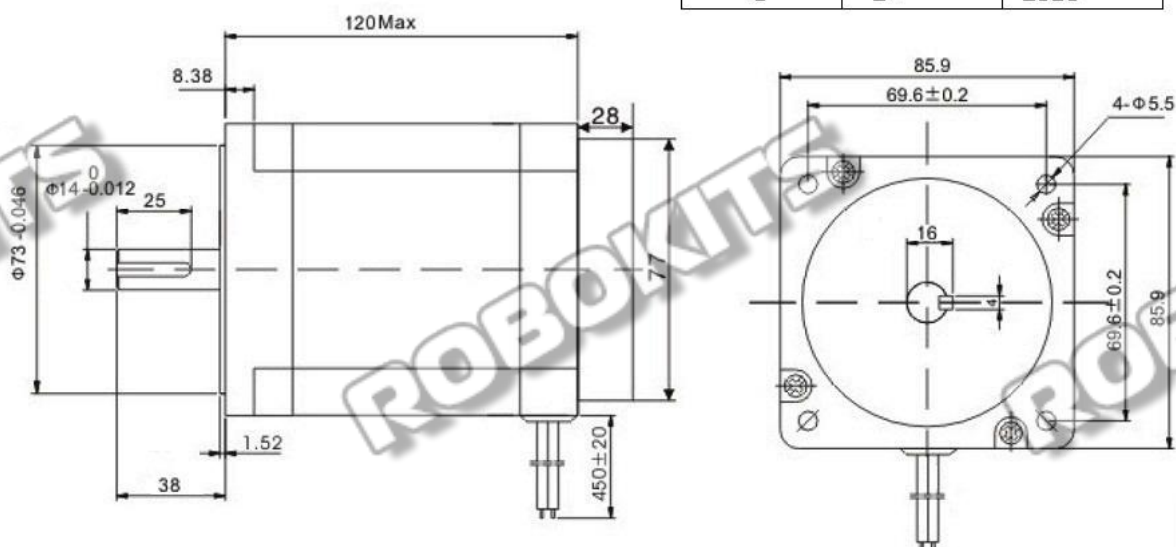

All Dimensions are in mm

Rhino Motion Controls

RMCS - 1052

31-03-2015 18:06:21

Sheet: 1/1